

— *ANVERA* —  
*2000*

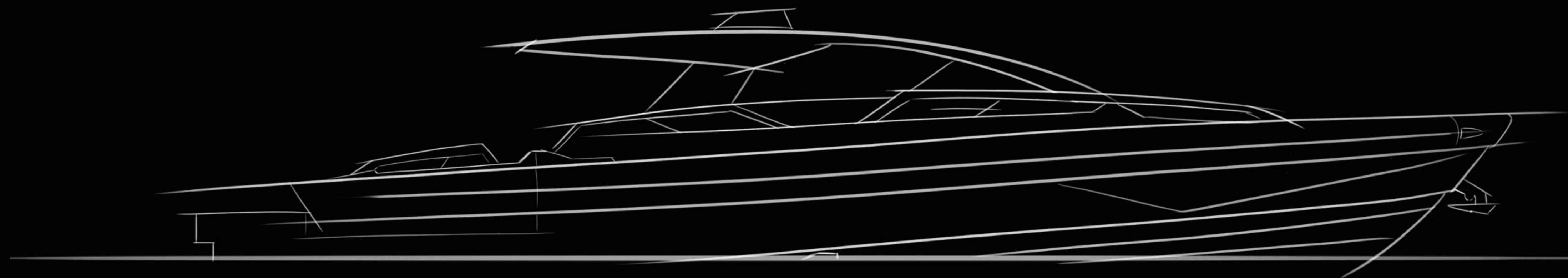

# The Hyperboat Redefining Luxury Performance

**Anvera 200-S** is a masterpiece of **high-performance boating** that merges **adrenaline** and **elegance**, born in Italy's **Motor Valley**.

A 20-meter flagship blends advanced offshore technology with motorsport-inspired design, delivering **speeds over 70 knots** in Racing version with remarkable sustainable performance.

With nearly 6 meters of beam and **expansive floating beach areas** totaling almost 40 square meters, Anvera 200-S offers unmatched **luxury, space and connection to the water, being free to live the sea**.

Produced in a **limited series**, is **fully customizable** reflecting the owner's vision. Hull has been designed in collaboration with Brunello Acampora Victory Design Studio and the whole boat design made by Marco Casali Too Design Studio.

More than just a boat, the Anvera 200-S is the **future of luxury performance on the sea**.























# GENERAL ARRANGEMENT



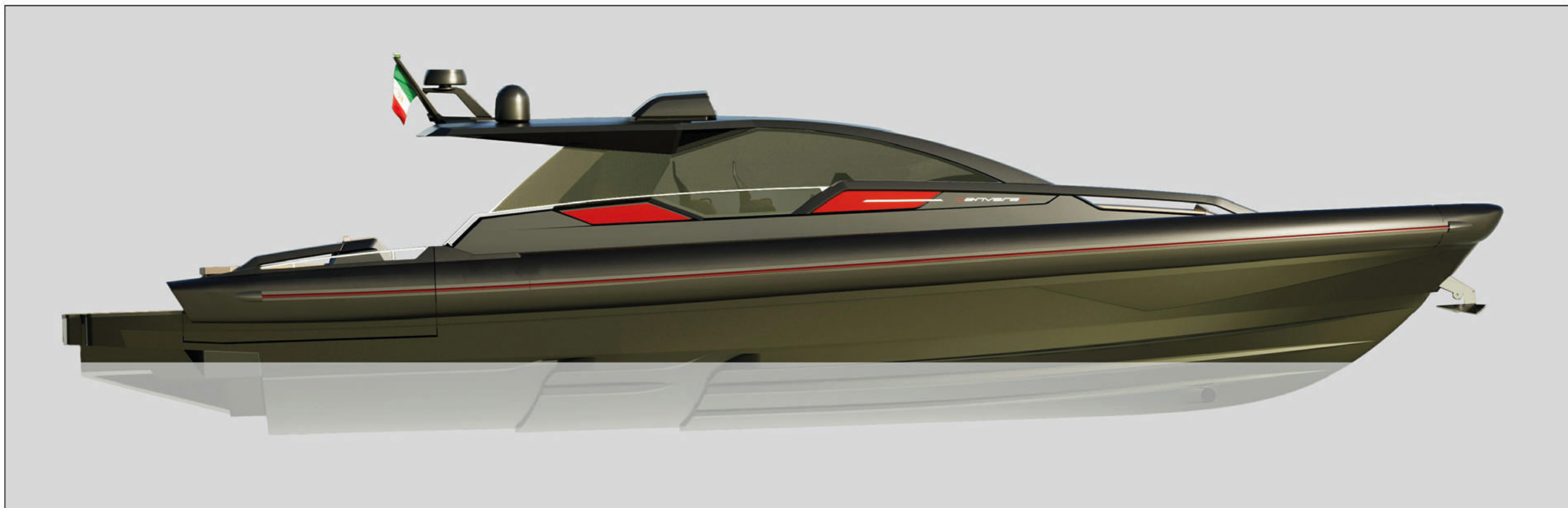

COUPÉ PROFILE

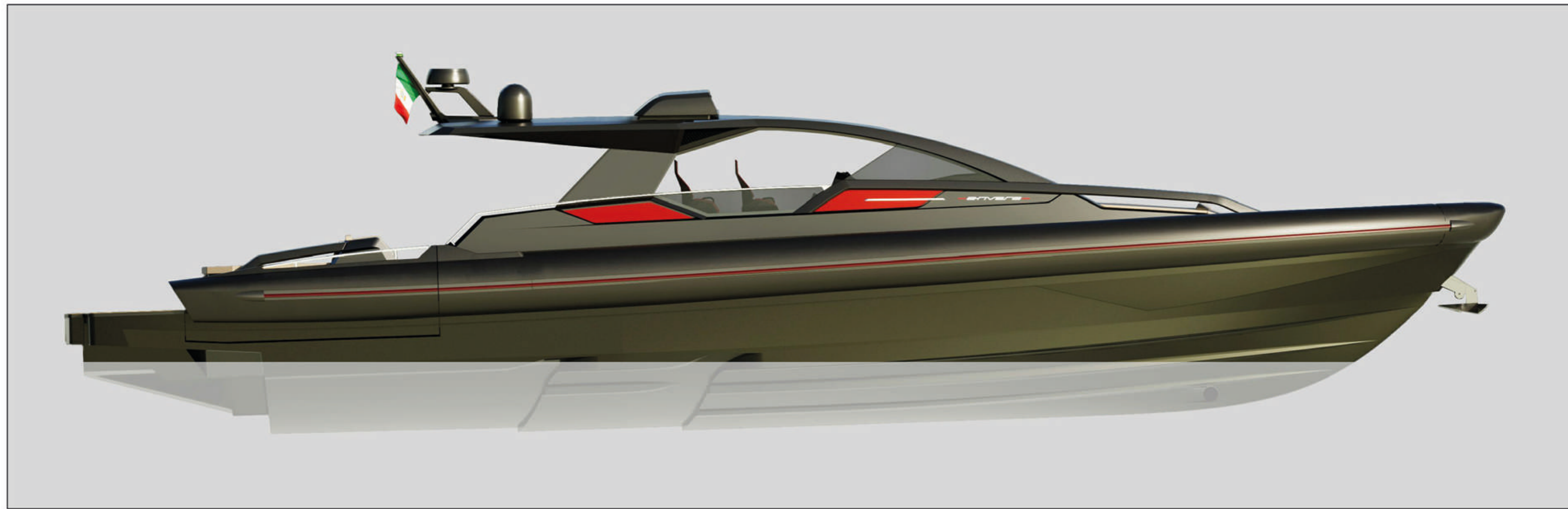

OPEN PROFILE



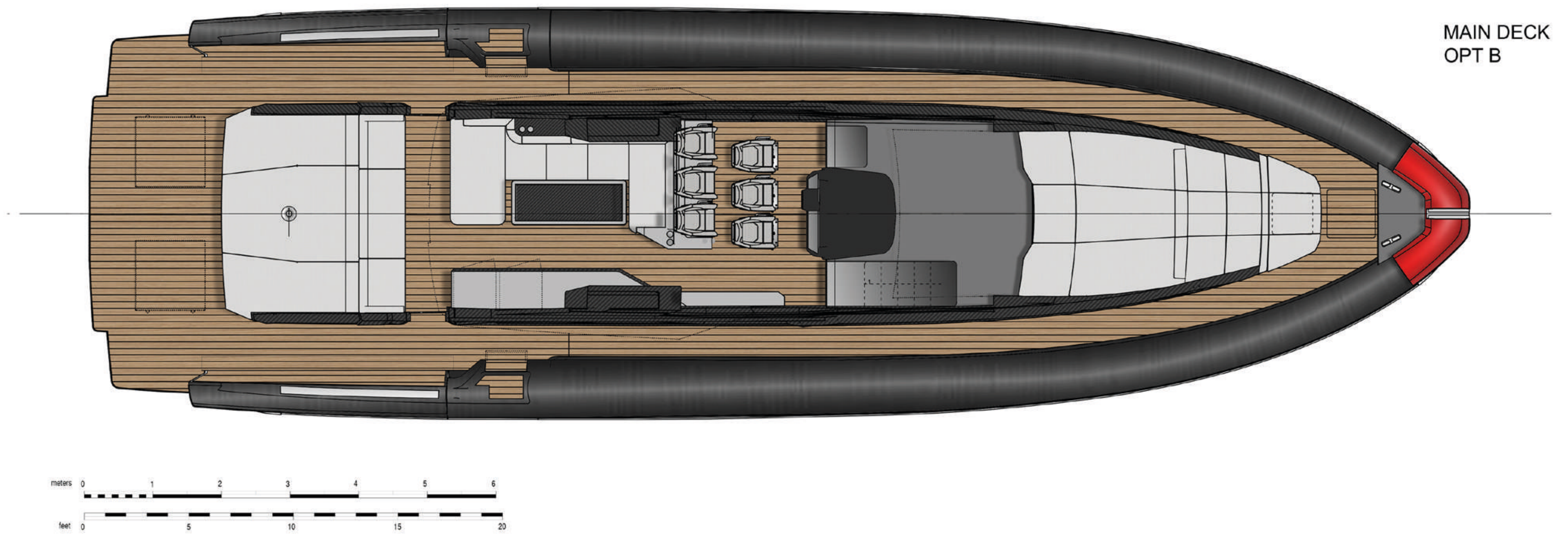
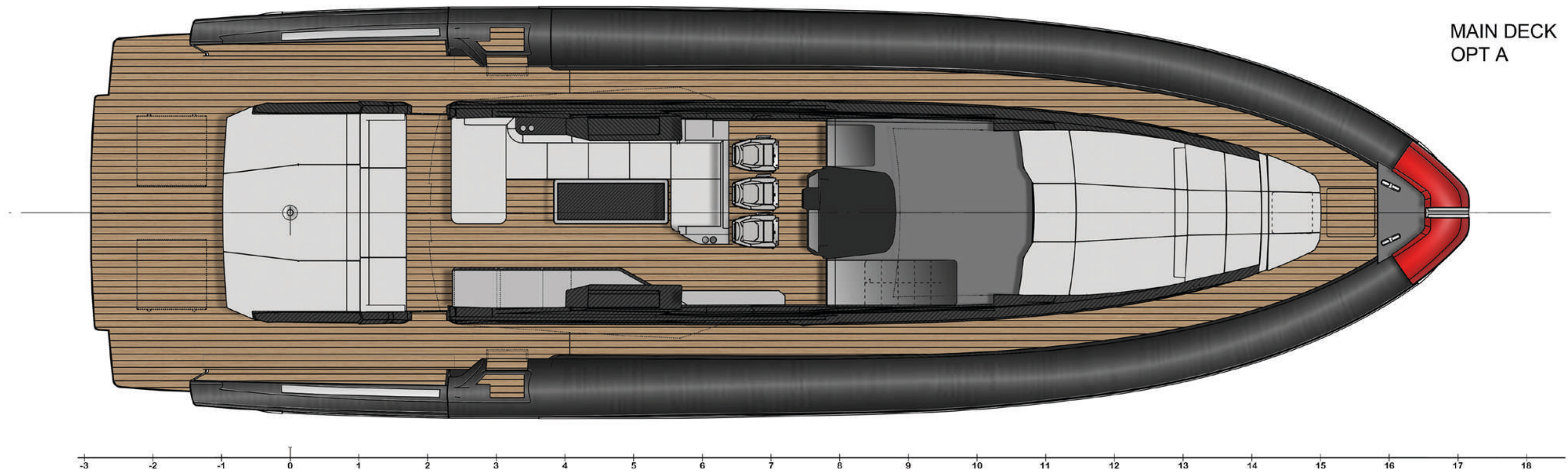







OTHER PROPOSAL 1

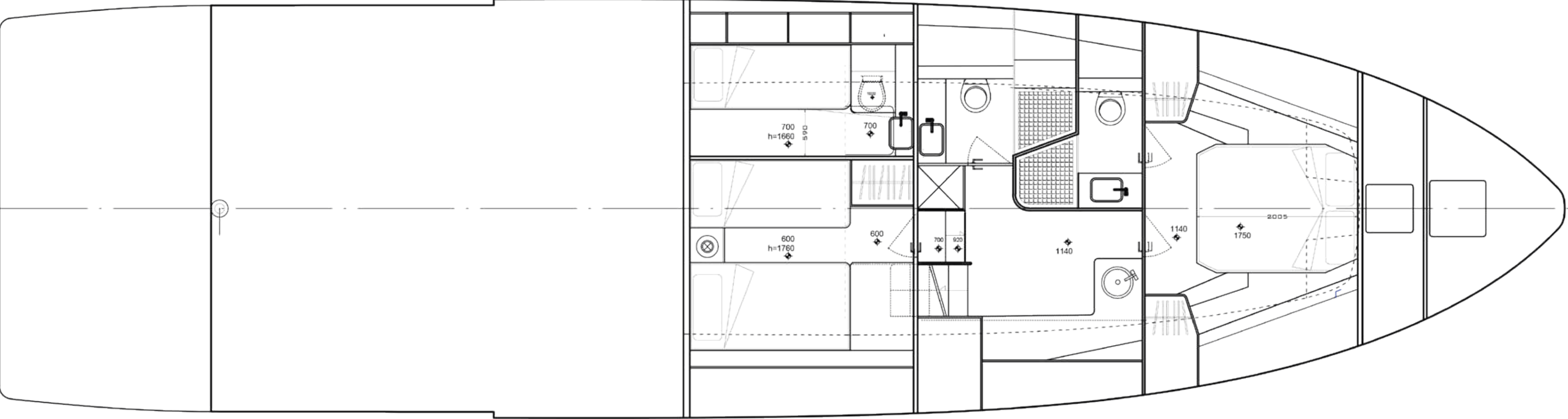
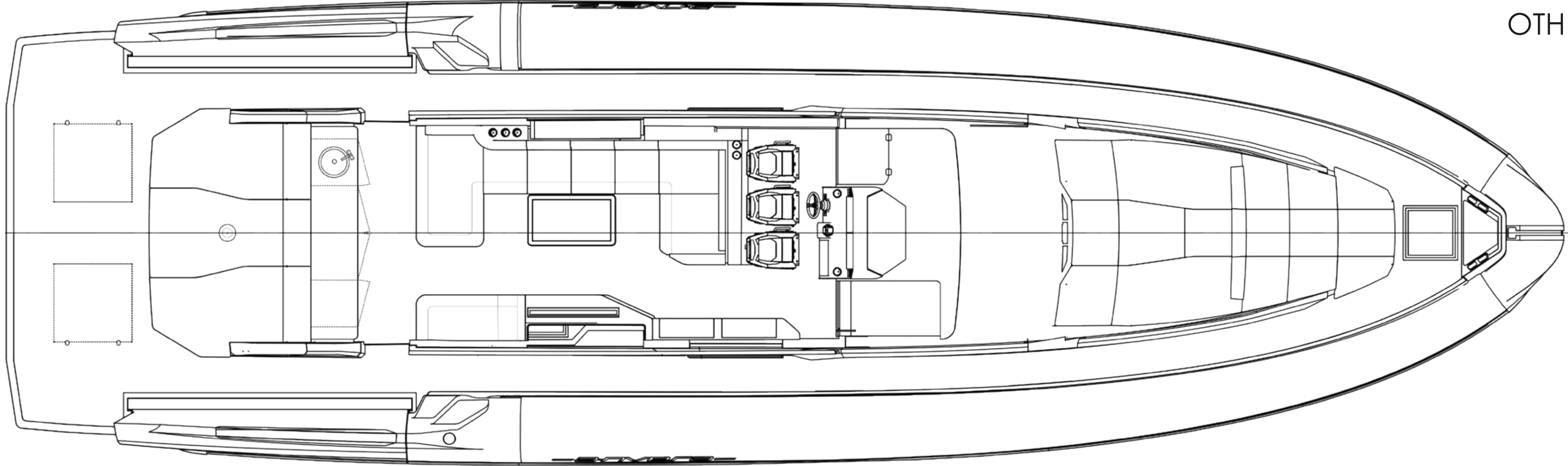



OTHER PROPOSAL 2

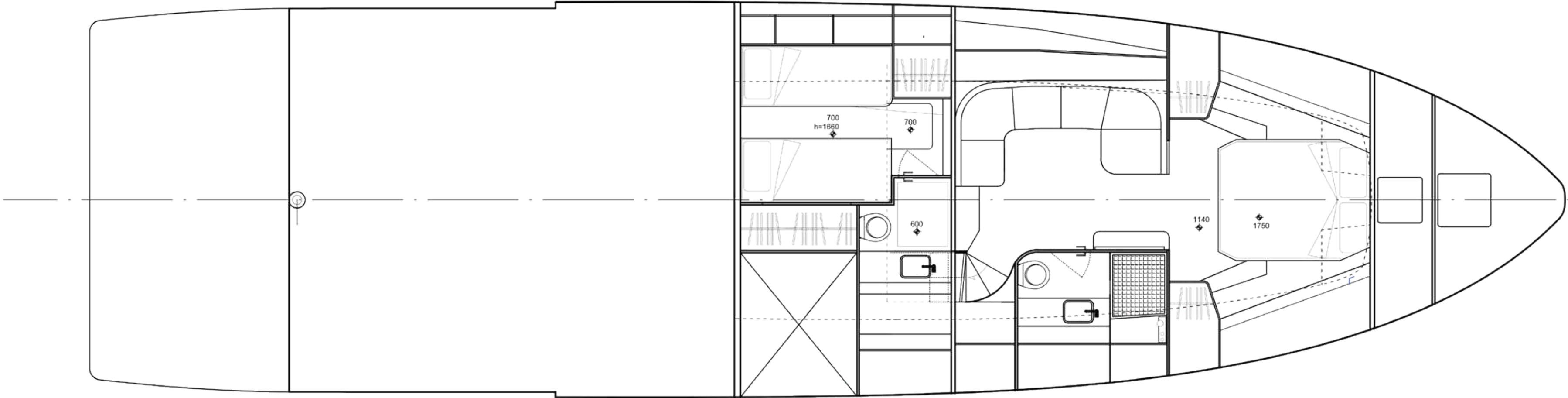
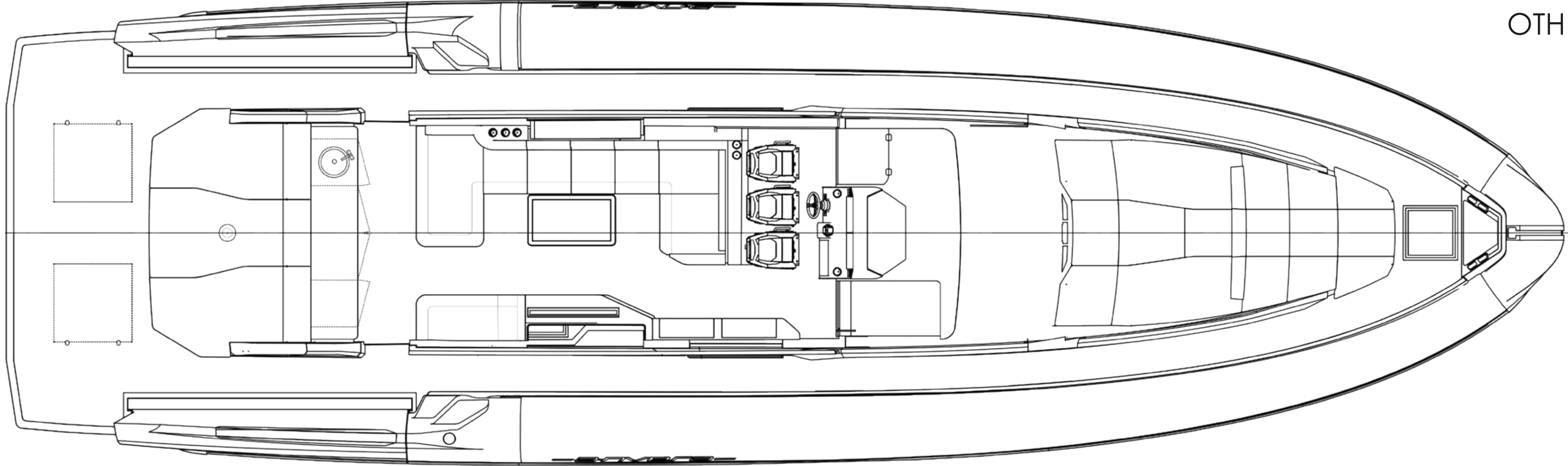



INTERIOR PROPOSAL A  
CLOSE BULKHEAD























INTERIOR PROPOSAL B  
OPEN BULKHEAD



















— *ANVERA* —  
*2000*

VS

— *ANVERA* —  
*SE*







**- ANVERA -**  
**200**

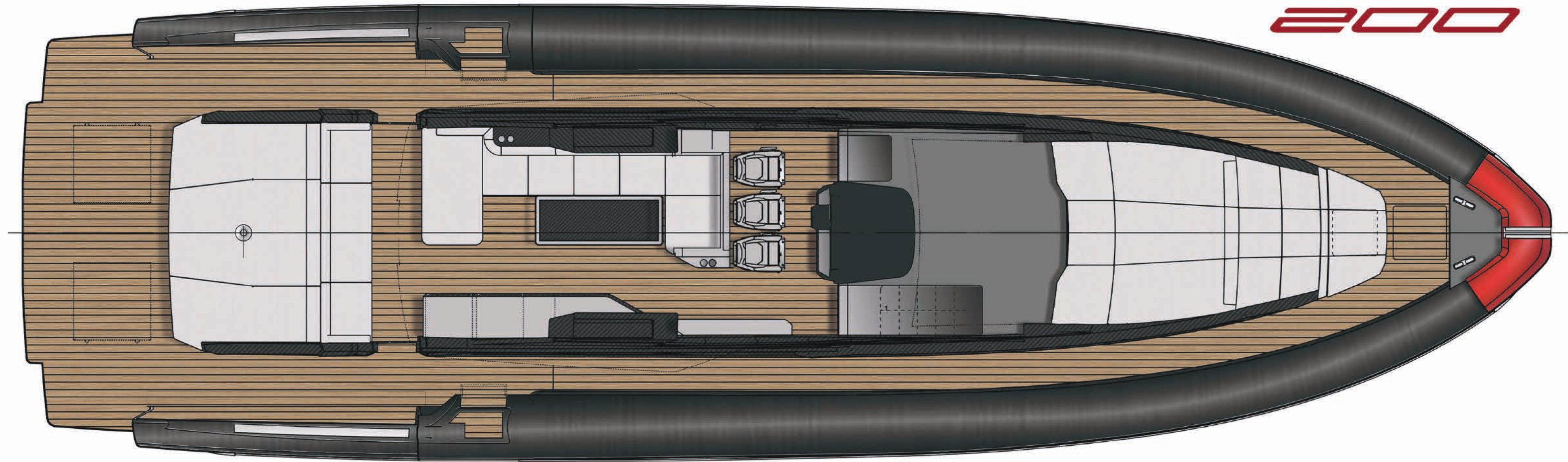

**- ANVERA -**  
**58**

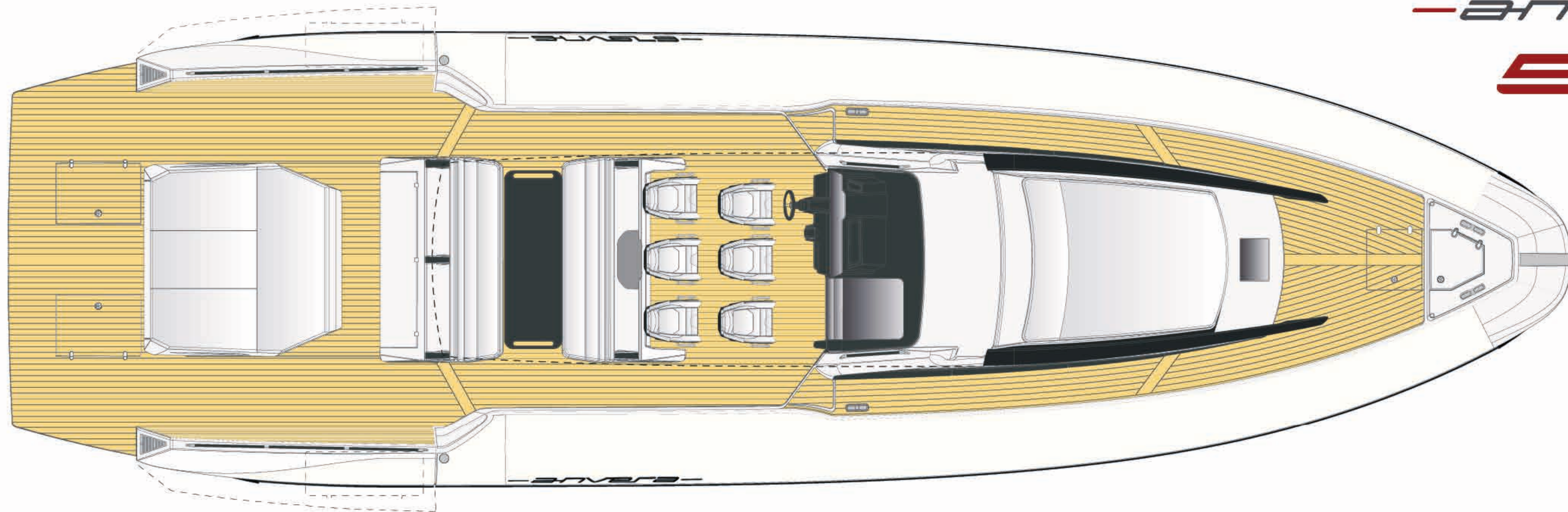



**-anvera-**  
**200**

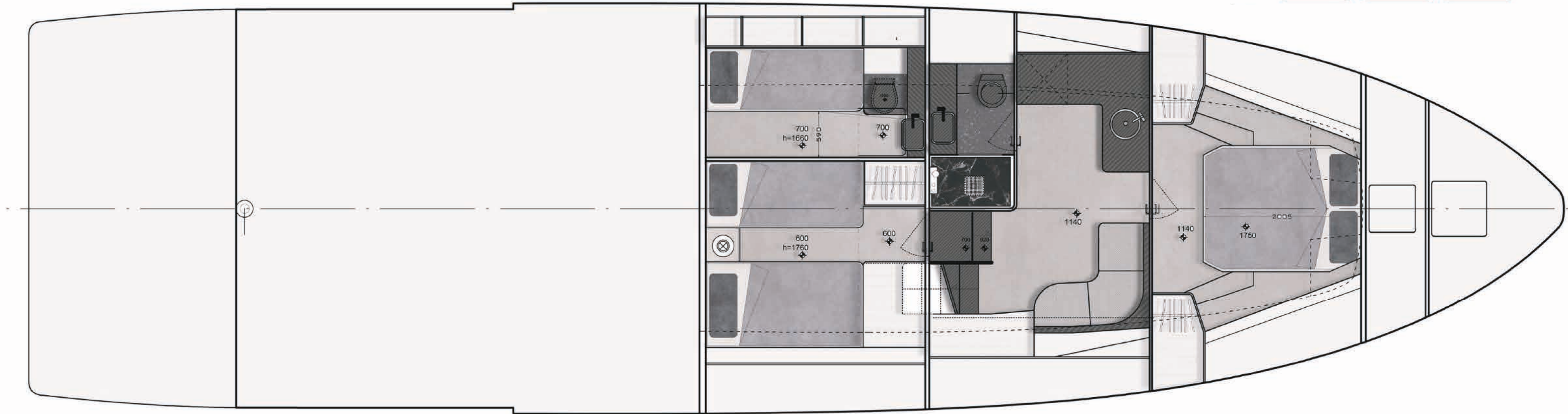

**-anvera-**  
**58**

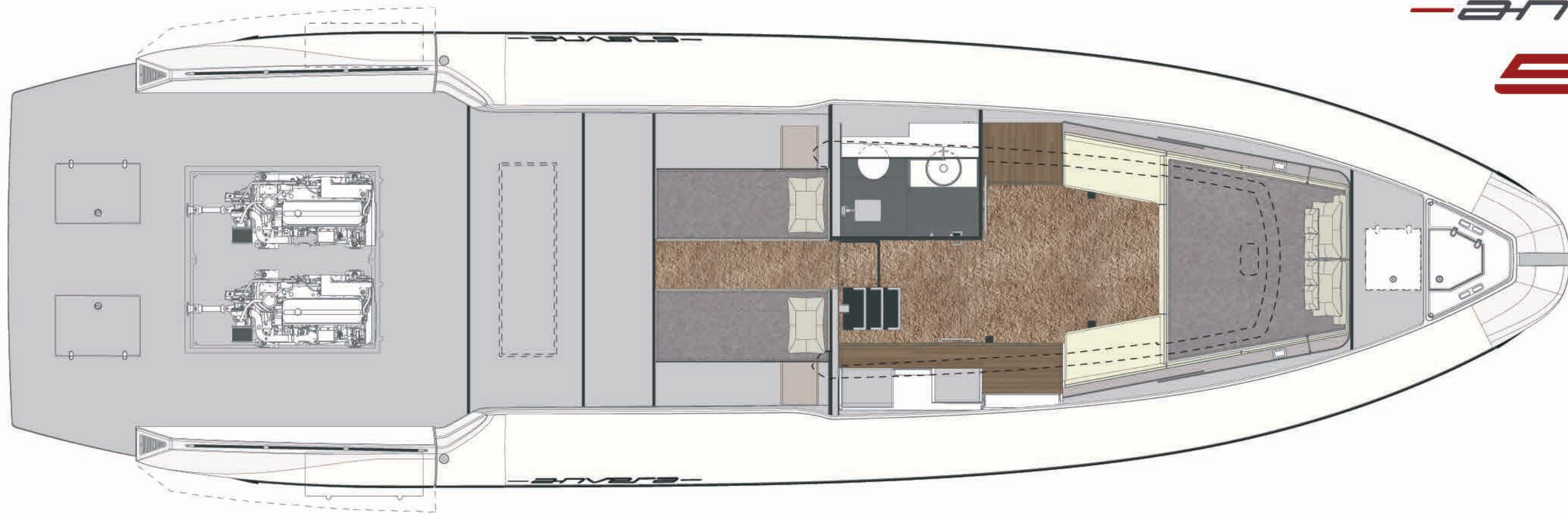



— *ANVERA* —  
*2000*